

NOTES

1. A HYDROGRAPHIC SURVEY WAS PERFORMED AT 4452 FERNCROFT, MERCER ISLAND WA ON DECEMBER 17, 2021.
2. HORIZONTAL AND VERTICAL CONTROL WAS BASED ON CITY OF BELLEVUE SURVEY STATION 2245.
3. HORIZONTAL DATUM IS NAD83(2011)(EPOCH 2010.00)
4. PROJECTION IS WASHINGTON STATE PLANE, NORTH ZONE. UNITS ARE US SURVEY FEET.
5. VERTICAL DATUM IS USACE LAKE WASHINGTON DATUM AND WAS ESTABLISHED AT THE SITE BY APPLYING THE GEOID12B MODEL TO THE PUBLISHED ELLIPSOID HEIGHT AT "2245" AND A +3.25 FT ADJUSTMENT TO USACE DATUM FROM NAVD88.
6. HORIZONTAL AND VERTICAL POSITIONING OF THE SURVEY VESSEL WAS BASED ON RTK GPS POSITIONING.
7. THE HYDROGRAPHIC SURVEY WAS PERFORMED WITH A RESON 7125 SV2 MULTIBEAM, APPLANIX POSMV V4 WAVEMASTER POSITIONING SYSTEM, RESON SV70 VELOCIMETER AND AML-3 SOUND VELOCITY PROFILER.

LEGEND

BATHYMETRIC CONTOURS REPRESENT THE DEPTH BELOW THE OHWM DATUM DEFINED AS 21.8 FT ON THE USACE LAKE WASHINGTON DATUM.
 SOUNDINGS DISPLAYED ARE SPOT SOUNDINGS GENERATED FROM THE UNDERLYING SURVEY SURFACE AT A 25-FOOT SPACING.
 CONTOUR INTERVAL IS 1-FOOT
 AERIAL IMAGERY SOURCE IS THE KING COUNTY PARCEL VIEWER. IT IS SHOWN FOR GENERAL REFERENCE ONLY.
 BATHYMETRIC IMAGES ARE 1-FT RESOLUTION IMAGES FROM A MEAN GRIDDED DATA SET.

GEODETICS

HORIZONTAL DATUM: NAD83(2011)
 PROJECTION: STATE PLANE, WA NORTH
 VERTICAL DATUM: USACE LAKE WASHINGTON
 UNITS: US SURVEY FEET
 CONTROL POINT "2245"
 NORTHING: 212680.14
 EASTING: 1305851.50
 ELEVATION (USACE): 23.56
 ELEVATION (NAVD88): 20.31

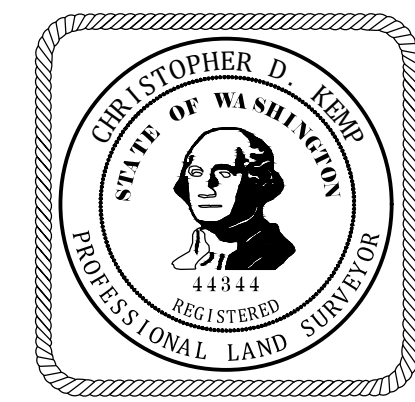
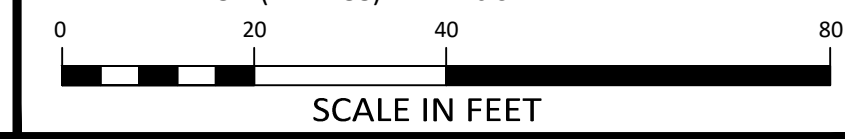

DATE: _____



ECCO

7413 GREENWOOD AVE N., SEATTLE, WA 98103

**4452 FERNCROFT
HYDROGRAPHIC SURVEY**

LOCATION:	MERCER ISLAND, WA	SUB-LOCATION:	LAKE WASHINGTON
SURVEY DATE:	12/17/21	DRAWING TITLE:	AFFIDAVIT OF LAKE DEPTH SURVEY
DRAWING DATE:	12/21/21	SHEET NAME:	CONTOURS
DRAWN BY:	CDK	SHEET:	1 OF 1

